

Daniel Hughes

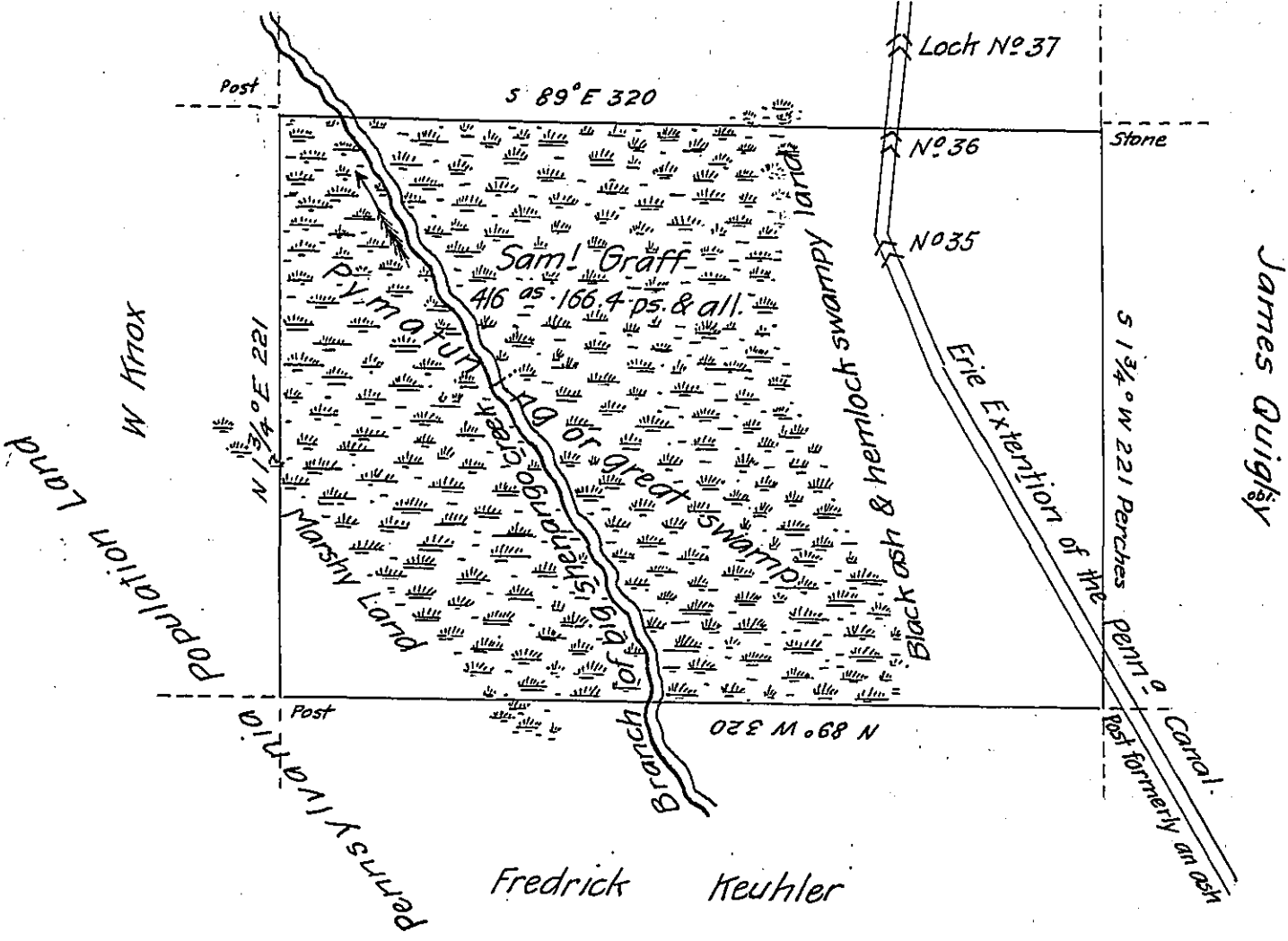

In pursuance of the settlement of Samuel Graff: commenced in September 1833 was surveyed on the fifteenth day of May 1840 for said Samuel Graff the above described tract of land situate in Sadsbury Township Crawford County Penn^a. Containing four hundred sixteen acres one hundred and sixty six & 4 tenth-perches of land & the allowance of six per cent for roads &c.

H. H. Laughlin Dep. Sur.
of Crawford Co. Pa.

Jacob Sallade Esqr. Sur. Gen.

I certify hereby that it does not appear from the books or documents in my office that the above described tract of land has been otherwise appropriated by warrant or otherwise

H. H. Laughlin D.S.

IN TESTIMONY that the above is a copy of the original remaining on file in the Department of Internal Affairs of Pennsylvania, made conformably to an Act of Assembly approved the 16th day of February, 1833, I have hereunto set my Hand and caused the Seal of said Department to be affixed at Harrisburg, this sixteenth day of January 1905

Loac N. Brown
Secretary of Internal Affairs.